



Europe New Deal P 699 GLG

LOW PROFILE 6.99 M WITH TWIN BEDS AND
ADJUSTABLE VOLUME BATHROOM.

PRIMARY TECHNICAL INFORMATION

IT
2026

10
TOTAL BODY PROTECTION

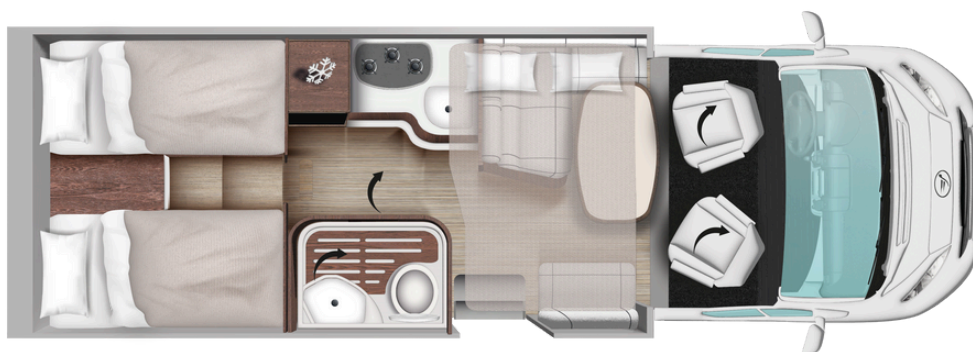

FIAT

FIAT DUCATO
2,2 MJ - 140 HP



4



4 with drop-down bed
3 low profile

Upholstery



FIRENZE
standard - synthetic leather



MADRID
optional - microfiber

DIMENSIONS

	with drop down bed	low profile
Length	6,99 m	6,99 m
Width	2,35 m	2,35 m
External / internal height	3,05 / 2,08 m	3,05 / 2,08 m
Maximum allowable mass	3500 kg	3500 kg

PLACES

	with drop down bed	low profile
Seats	4	4
Berths	4	3
Rear beds (centimeters)	dx 189x83 - sx 185x83	dx 189x83 - sx 185x83
Additional bed in convertible dinette (cm)	217 x 100 / 63 (optional)	217x100/63
Drop-down bed (cm)	190x128(107)	--

LOCKER AND SYSTEMS

	with drop down bed	low profile
Useful locker opening (cm)	117x87(72) - 117x87(72)	117x87(72) - 117x87(72)
Maximum height of the internal garage (cm)	119	119
Kitchen hobs	3	3
Compressor fridge	145 l	145 l
Heating System	Combi 6KW - CP Plus	Combi 6KW - CP Plus
Maximum tank capacity: clean water when in motion / at rest / wastewater (l**)		20 / 145 / 135
Maximum capacity of gas locker (kg)		15

Discover by clicking
here

the characteristics and
specifications of the
America Compact range.



MASS IN RUNNING ORDER

Includes the weight of the empty base vehicle, the driver (75 kg), fuel and fluid tanks filled to at least 90%, fresh water tank filled to maximum capacity as declared by the manufacturer ref: 'travel', gas cylinder for domestic use with a maximum weight as declared by the manufacturer. The mass in running order, and consequently the payload and/or travel seats, may vary depending on the installed accessories.

The Mass in Running Order value shown in the commercial documentation is the value calculated during the homologation procedure and may differ from the delivered vehicle's value due to production tolerances. The legally allowed deviation is ±5%. During the purchasing process, it is necessary to verify the weight of the optional equipment intended to be installed on the vehicle.

PAYLOAD

It is the difference between the technically permissible maximum mass and the mass in running order. The payload includes elements for habitation, passengers 'transported' as defined by the manufacturer (excluding the driver), and personal belongings. The minimum payload calculation is based on the following parameters: 75 kg for each passenger (excluding the driver), 10 kg of luggage for each passenger and the driver, 10 kg for each meter of vehicle length. The remaining payload can be used for installing accessories or additional luggage.

Anything not included in the standard version of the vehicle, both cell and chassis, increases the mass in running order and consequently reduces the payload, potentially reducing the number of approved seats. Available payloads result from the difference between the technically permissible maximum mass and the mass in running order. During the purchasing process, it is necessary to verify the weight of the optional equipment intended to be installed on the vehicle. The weight of non-standard accessories is not included in the mass in running order. Additional accessories and devices reduce the payload by an amount equal to their weight; the weight impact of individual accessories is listed in the appropriate column in the price list or can be requested at our dealers' shops. Please note that the law does not allow exceeding the technically permissible maximum mass, which can be found in the technical sheet specifications. Ensure that the maximum axle loads and the technically permissible maximum mass are not exceeded during full vehicle loading. The number of approved seats may vary depending on the regulations of individual countries regarding circulation.



ARCA®